



ISO WINDOW F11 IW (INTERIOR TWO-WAY)

The window tape serves as seal for connecting building gaps in accordance with RAL guidelines and ÖNORM B 5320. The window tapes for indoor use are vapour retardant and airtight to 600 Pa and conform to ÖNORM EN 12207 and for outdoor use tapes are vapour permeable and resistant to driven rain to 600 Pa and conform to ÖNORM EN 12208. ISO WINDOW F11 consists of a 3-layer fleece that can be plastered over and has two two-way acrylic adhesive strips attached.

FIELD OF APPLICATION

- for window installation
- for indoor use

ADVANTAGES

- strong bonding of the adhesive acrylic strip on all types of window frame and on a variety of substrates such as OSB, wood, vapour retarders, ...
- tear-resistant and robust
- can be plastered over and painted over
- compatible with acrylic glass and polycarbonate

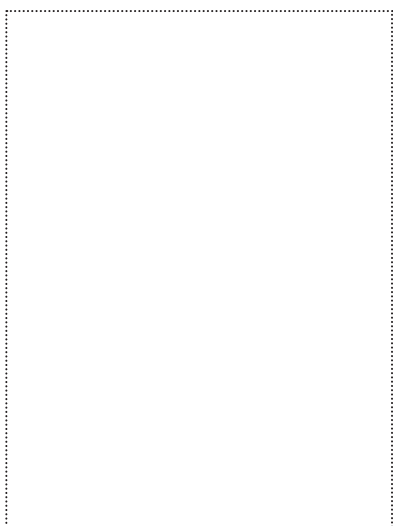

AVAILABLE IN THE FOLLOWING SIZES

Roll width	50 mm	75 mm	100 mm	150 mm
Roll length	25/50 m	25/50 m	25/50 m	25/50 m
Carton contents / rolls	7	5	3	2

PRODUKT DATA

Material	PP - fleece + alu coating
Thickness	0,52 mm
Fire performance	B2 / E
UV resistance	3 months
Storability	12 months
Storage	(+ 10 °C - + 25 °C) warm and dry
Working temperature	- 5 °C - + 40 °C
Temperature resistance	- 40 °C - + 80 °C
SD-Value	40 m

GUIDELINES FOR USE

ISOWINDOW F11 IW (INTERIOR TWO-WAY)

ISOWINDOW F11 window tape two-way (Interior and Exterior) are attached to the window casement before the windows are fitted. The fleece side of the tape can be plastered over and painted over and must face outwards. The aluminium-clad or white side is attached to the wall, wood, OSB or vapour barrier using acryl adhesive strips. The materials used must be free from dust and grease and substrates must be dry and supporting.

On very porous and highly absorbent substrates such as concrete, plaster, uncoated steel, untreated wood, we recommend priming with UNI PRIMER or BUBI LF Bonding Primer. The side of the tape that is covered with fleece can be plastered over with standard materials or painted over with dispersion coating. If a foil was supposed to be covered with plaster, the conglutination with the underground has to be done over the full area of the tape.

(1)
Position the window frame with the inside facing upwards. Cut the window tape F11 IW (beige and silver) allowing approx. 12 cm excess length. Carefully press the attachment strips on to the window frame.

(2)
Make a fold at the corners, pressing the window tape firmly up to the corner of the window frame, then push further material behind to create a fold. Repeat this procedure at all 4 corners. The folds created serve as corner seals.

(3)
The window tape F11 AW (white and black) is attached to the outer side of the window frame in the same way. The window frame with the window tapes attached can now be lifted into the window opening. Fill the connection joint with foam or with insulation material (e.g. ISOWINDOW Insulating Rope, ISOWINDOW Soft Cell Foam).

(4)
After insulation of the joint, pull off the backing paper from the acryl adhesive strip and apply pressure to attach the window tape to the wall, wood, OSB or vapour barrier. The greater the pressure applied, the better the adhesion!

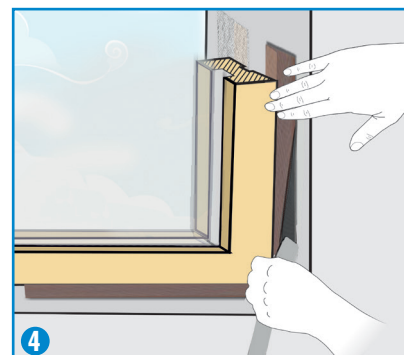
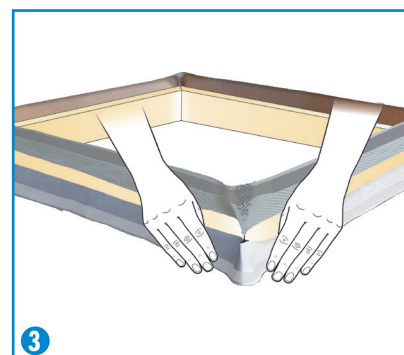
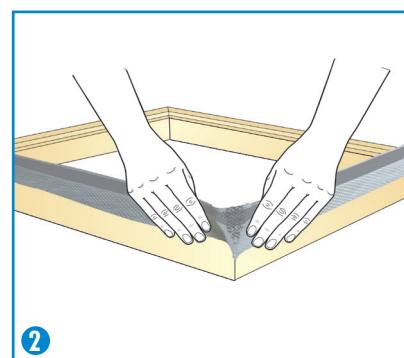
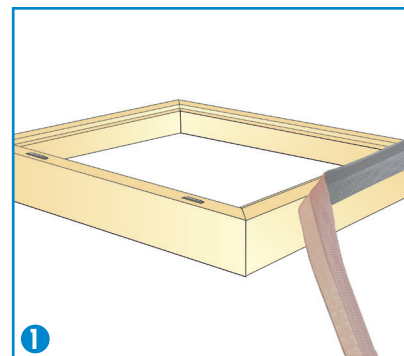

ISOCELL GmbH
Gewerbestraße 9
5202 NEUMARKT AM WALLERSEE | Österreich
Tel.: +43 6216 4108 | Fax: +43 6216 7979
office@isocell.at

ISOCELL SCHWEIZ AG
Herbergstrasse 29
9524 ZUZWIL | Suisse /Schweiz
Tel.: +41 71 544 47 20
office@isocell.ch

ISOCELL FRANCE
170 Rue Jean Monnet | ZAC de Prat Pip Sud
29490 GUIPAVAS | France
Tél.: +33 2 98 42 11 00 | Fax: +33 2 98 42 11 99
contact@isocell-france.fr

ISOCELL BUREEL BELGIË
Außenborner Weg 1 | Schoppen
4770 AMEL | Belgique
Tel.: +32 80 39 90 58 | Fax: +32 80 39 97 68
office@isocell.be

ISOCELL Sverige AB
Gamla Stallet | Stora Wäsby
194 37 UPPLANDS VÄSBY | Sverige
Tel.: +46 10 130 25 01
office@isocell.se

ISOCELL
www.isocell.com