

Technical data sheet

OMEGA G50 Facade Lining

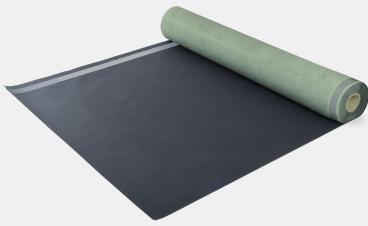

is a vapour-permeable, UV-resistant facade underlay with 2 two-way acrylate adhesive strips*. The underlay is indefinitely weather-resistant and permanently UV-stabilized. The special coating enables use in facade constructions behind semi-transparent and partly open facades e.g. of wood, expanded metal or glass. To protect the facade underlay from mechanical damage, care must be taken that the open portion of the facade is limited to < 50 % and/or has a maximum joint opening of 50 mm. **For windtight adhesion at panel edges and overlaps with SK DUO features and/or OMEGA UVKB Facade Tape (vertical joint adhesion), the open portion of the facade is limited to < 50 %. Greater joint spaces require object-specific approval from ISOCELL. *Only for the SK-DUO version **Only for the Standard version

ADVANTAGES

- rain-tight
- wind-tight
- UV-stabilized
- extremely diffusive
- easy to cut
- anti-glare

FIELD OF APPLICATION

- under wood facades with up to 50 mm wide joints

RECOMMENDED PRODUCTS

	OMEGA UVKB Facade Tape
	OMEGA FA GD2 Pipe Sleeve
	OMEGA FROZEN Adhesive Paste
	OMEGA N55 Adhesive

AVAILABLE DIMENSIONS

Article number	Type	Roll width	Roll length	Rolls / Pallet	Total area
20MFAS1	SK DUO	1.5 m	50 m	30 rolls	2250 m ²
20MFAS2	Standard	3 m	50 m	20 rolls	3000 m ²

TECHNICAL DATA

sd-value	0.18 ± 0,03 m m	Material composition	PES fleece with TPU coating on one side, two acrylic adhesive strips on both front and back edge
Elongation (EN 12311-1) lengthwise	25 %	Elongation (EN 12311-1) crosswise	30 %
Tear propagation resistance (EN 12310-1) lengthwise	150 N	Tear propagation resistance (EN 12310-1) crosswise	160 N
Thickness	0.35 mm	Temperature resistance	-30–80 °C
Weight	225 g/m ²	Colour	Black
Temperature resistance	EN 13859-2	UV-resistance	Durable
Resistance to water flow (EN 1928)	W1	Tensile strength - lengthwise	400 N/50 mm
Tensile strength - crosswise	370 N/50 mm	Tensile strength	EN 12311-1
Long-term behaviour	Permanent long-life under facades with up to 50 mm wide joints	Long-term behaviour	EN 1296 / EN 1297
UV-resistance uncovered	12 months	Fire performance (EN 13501-1 / EN 11925-0)	B-s1, d0

OMEGA G50 Facade Lining

TIPS FOR PLANNING

The surface must be dry and clean, and there should be no sharp corners. The size of the wooden or metal substructure should be adjusted to match the width of OMEGA Facade Lining. Calculations should take into consideration overlaps of a minimum of 10cm. For mounting of OMEGA Facade Lining (mechanically or by adhesion) the bearing surface for attachment of the lining must be a minimum of 5cm. The adhesive functions as a seal and does not take the place of a strong bond. OMEGA Facade lining must subsequently be fixed mechanically. Battens / back ventilation must be provided between the lining and the visible wooden cladding!



(1) ROLL MEASUREMENT

Standard rolls can be cut to length using a circular saw / band saw. The cut edges must always overlap.

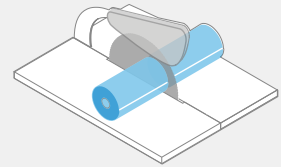

(2) STORAGE

OMEGA Facade Lining should be stored in a horizontal position and handled with clean hands and tools. Pay attention that OMEGA Facade Lining is not folded or bent.

(3) & (4) LAYING

Unroll OMEGA Facade Lining vertically from top to bottom (or horizontally from left to right). First position straight on one side and fix temporarily, then pull to the other three sides and guarantee that the OMEGA Facade Lining is tightly laid. Attach OMEGA Facade Lining to the supporting construction mechanically using tacker clips or similar. Secure all loose overlaps, corners and edges.

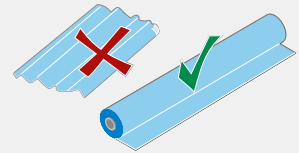

(5) ADHESIVE TECHNIQUE

Wind-tight adhesion at connections and overlaps of lengths of OMEGA Facade Lining are achieved using AIRSTOP FROZEN, OMEGA N55 Adhesive or OMEGA UVKB Facade Tape (Vertical joint bonding). When using SK DUO, adhesion at overlaps is made using the acrylate adhesive strips attached. Shake the adhesive well in the container and pour into the plastic bottle provided. Apply the adhesive in the area of the facade lining overlap, spread with a paintbrush and finally press on using a dispenser or clean cloth. Caution: do not let the adhesive flash off (so-called wet-in-wet adhesion).

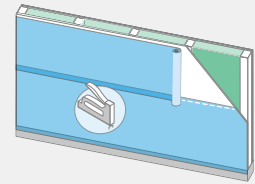

(6) CONNECTIONS

Use AIRSTOP FROZEN for connection to masonry or metal. Materials used must be free from dust and grease and the substructure must be dry and supporting. Always pre-treat connections on very absorbent substrates with Primer. Press OMEGA Facade Lining well into the applied sealant. Connection with metal, concrete, plastic and wood can also be carried out using OMEGA N55 Adhesive. Spread the OMEGA N55 on the substrate using a paintbrush, allow to flash-off and then bond wet-in-wet with an additional layer of OMEGA N55 and press the OMEGA Facade Lining on well. (Depending on the substrate adhesion of connections with OMEGA N55 can also be carried out in one process with wet-in-wet adhesion. As a rule we recommend an adhesion test.

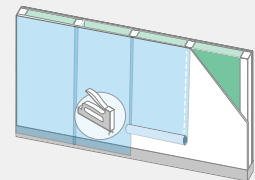

(7) WINDOW CONNECTIONS

OMEGA Facade Lining can be fixed to a wooden, PVC or metal window frame using AIRSTOP FROZEN, OMEGA N55 or OMEGA OMEGA UVKB facade tape. Application as above, see 'CONNECTIONS'.

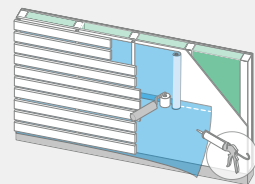

RESTORATION

Damaged spots can be glued wet-in-wet with a segment of Facade Lining and using OMEGA N55 Adhesive.

